



ELECOM DE-NEST-5000 Power Bank Instruction Manual

[Home](#) » [ELECOM](#) » ELECOM DE-NEST-5000 Power Bank Instruction Manual 

Contents

- 1 [ELECOM DE-NEST-5000 Power Bank](#)
- 2 [Product Information](#)
- 3 [Name and function of each part](#)
- 4 [Product Usage Instructions](#)
 - 4.1 [Power ON/OFF](#)
 - 4.2 [Gear Mode](#)
 - 4.3 [Charging the Product](#)
 - 4.4 [How to Charging a Smartphone or Tablet:](#)
- 5 [Specifications](#)
- 6 [Safety Precautions](#)
- 7 [Limitation of Liability](#)
- 8 [Documents / Resources](#)
 - 8.1 [References](#)
- 9 [Related Posts](#)

ELECOM

ELECOM DE-NEST-5000 Power Bank



Product Information

- **Model:** DE-NEST-5000/DE-NEST-5000A/DE-NEST10000A/DE-NEST15000A
- **Language:** English
- **Manual:** Power bank

Name and function of each part

- DE-NEST5000A: 5, 13

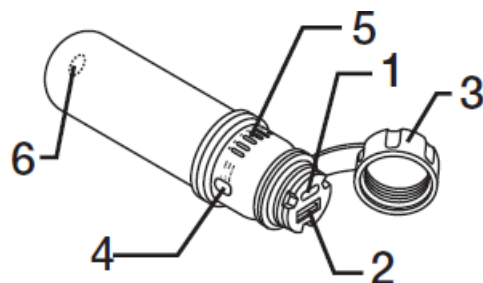

- DE-NEST10000A: 5, 3

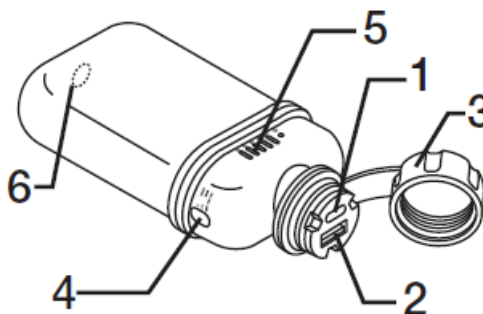

- DE-NEST15000A: 6, 4, 2

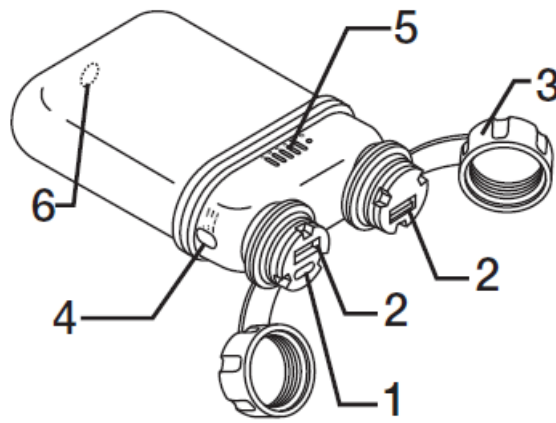

Features

1. USB Type-C® port (input/output)

* DE-NEST-10000A and DE-NEST-15000A support PowerDelivery.

2. USB-A port (output)

3. Cap

4. Power button

The printed mark indicates the number of times to press the power button.

ON/OFF

Press and hold

GEAR

Press twice quickly (double click) to change to gear mode. CHECK

Press once to light up the remaining charge LED.

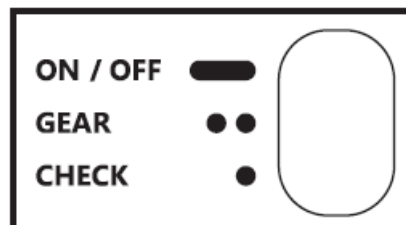

5. LED indicator

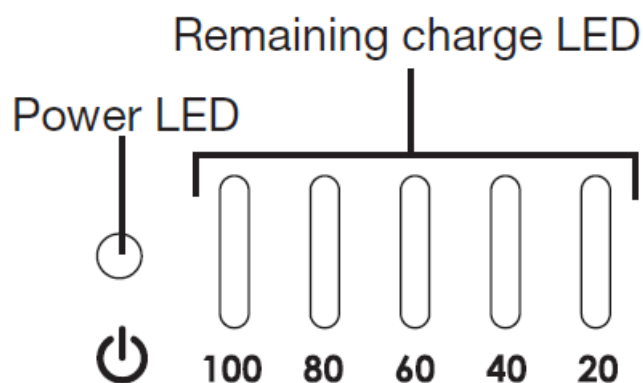

6. Tripod mount (Bottom)

Product Usage Instructions

Power ON/OFF

Press and hold the power button (1.5 s and above) to turn this product ON/OFF.

- This product will turn ON automatically when something is connected to the USB port, whether for charging or when using with NESTOUT gear.
- If nothing is plugged in, this product will turn OFF automatically after approximately 2 hours.



Checking the Remaining Charge:

Short press the power button (1 second or less). The number of lit up LEDs corresponds to the amount of charge left.

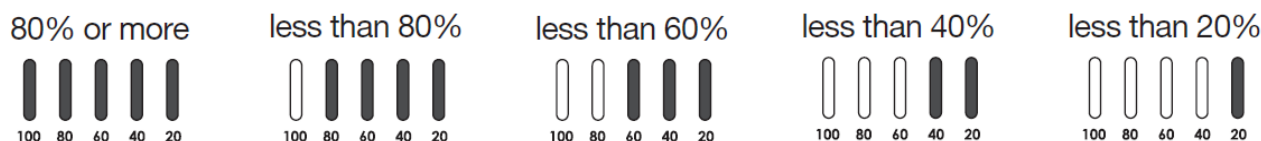

Gear Mode

Use this mode with NESTOUT gear.

This product can be used continuously for a long time (approximately 12 hours) when the brightness of the LED is low.

To switch to gear mode, press the power button twice quickly (double click).

- Gear mode extends the automatic turn OFF time to approximately 12 hours when used the brightness is low or when nothing is connected.

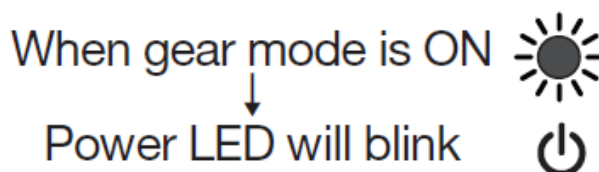

This product can be used with various outdoor gear, such as an LED lantern, by attaching separately sold parts. (Please make sure to remove the parts from this mobile battery after use. Leaving them attached will deplete the charge.)

Charging the Product

To charge the product, follow these steps:

1. Connect the charging cable to the USB Type-C port of this device.
2. Connect the other end of the attached charging cable to an AC charging adapter.
3. This product will start charging when the AC charging adapter is plugged into a household power outlet.

E.g. DE-NEST15000A

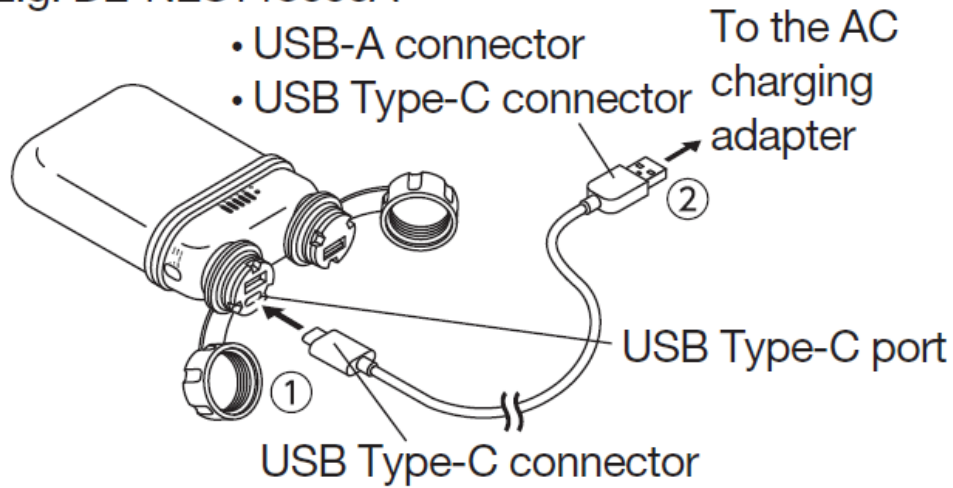

Note:

- USB Power Delivery of 18 W and above is recommended for the AC charging adapter. You may not be able to charge it using your PC, or it may take longer to charge.
- Please ensure that the cable is removed after charging. Leaving the cable attached may lead to breakage or damage to the connector.
- When charging, the LED light on the portable power charger will blink according to the amount of battery left.
- The device is fully charged when the LED light are either all lit or all not lit.
- This device does not come with an AC charging adapter. Please prepare an AC charging adapter with USB-A port when using with the included cable.
- Do not plug in any cable other than a USB-A — USB Type-C cable.

How to Charging a Smartphone or Tablet:

Basic charging method

1. Connect the charging cable to this product.
2. Connect the other end of the attached charging cable to your device.
If charging does not begin automatically, press and hold the power button (approximately 1.5 seconds and longer) to begin charging.
3. Once charged, for your safety, remove the charging cable by following the procedures described in the illustration in the reverse order of ②→①.

Note:

- When connecting a device to the product, make sure to follow the precautions for that device.
- This product may not charge up to the capacity indicated if it is in use or if the power is turned on, such as when it is charging your smartphone.
Leaving the product ON will deplete the remaining charge. Please ensure that this product is turned OFF and that the cable is removed when it is not in use.

To use USB Power Delivery mode

1. Connect the charging cable into the USB Type-C port while the power lamp is off.
 - DE-NEST-5000 does not support Power Delivery.
 - USB Power Delivery can be used for charging this product or charging devices such as your smartphone.
 - USB Power Delivery mode can only be used with USB PD (Power Delivery) supported devices. *
Smartphones or other devices can be charged at normal output (5 V) from the USB Type-C port when the power light is on.

Simultaneous charging

You can charge your device and this product at the same time by connecting them as per the diagram.

1. Start charging your device using this product.
2. Charging of this product will begin automatically when the connected device is fully charged or when this product's charge reaches 0%.
3. Charging of the connected device will automatically restart as soon as this product is fully charged. When both this product and your device are fully charged, charging will stop.

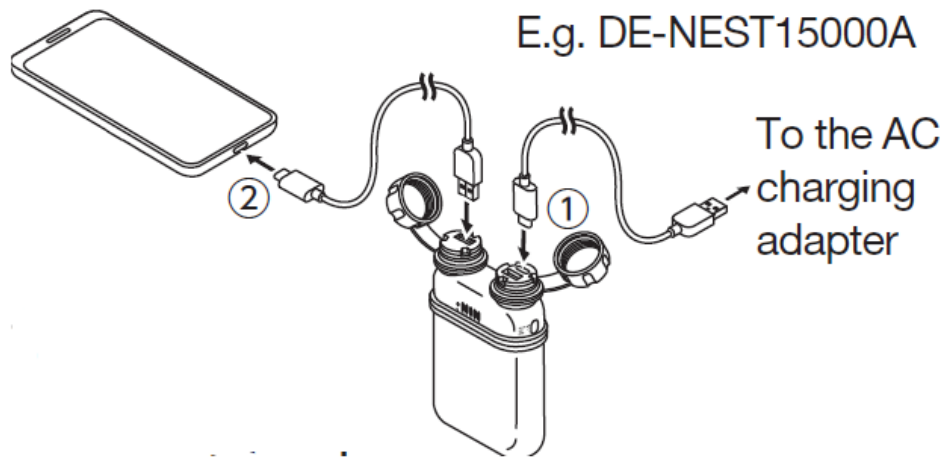

To charge Bluetooth earphones and other small peripherals

Connect small electronic devices such as your Bluetooth earphone or headset to the USB-A or USB Type-C port to charge.

- Depending on your device, this product will turn OFF automatically after approximately 2 hours.
- When using a 5V/3A AC charger.
- When using an AC charging adapter with USB Power Delivery of 18 W and above.

Specifications

Model number	DE-NEST-5000 series	DE-NEST-10000A series	DE-NEST-15000A series
Compatible models	iPhone or smartphones, tablet PCs, and other small electronic devices that charge using USB		
Connector type (Power input side)	USB Type-C (USB-C) port		
Rated input voltage	5 V	5 V/9 V	
Rated input current	3 A	3 A/2 A	
Connector type (power output side)	USB Type-C port ×1, USB-A port ×1		USB Type-C port ×1, USB-A port ×2
Rated output voltage	5 V	USB Type-C is 5 V/9 V, USB-A is 5 V	
Rated output current	Total 15 W	Total 20 W	Total 32 W
	USB Type-C (USB-C) is 3 A, USB-A is 2.4 A	USB Type-C is 3 A/2.22 A, USB-A is 2.4 A	
Battery type	Rechargeable lithium-ion battery		
Rated battery capacity	3.6 V 5000 mAh	3.6 V 10000 mAh	3.6 V 15000 mAh
Charging time	Approx. 2 hours *1	Approx. 2 hours 45 minutes *2	Approx. 3 hours 35 minutes *2
Dimensions (W×D×H)	Approx. 36 × 36 × 135 mm (Approx. 1.4 × 1.4 × 5.3 in.)	Approx. 61 × 36 × 126 mm (Approx. 2.4 × 1.4 × 5.0 in.)	Approx. 35 × 36 × 129 mm (Approx. 1.4 × 1.4 × 5.1 in.)
Weight	Approx. 240 g (Approx. 4.9 oz)	Approx. 241 g (Approx. 8.5 oz)	Approx. 364 g (Approx. 12.8 oz)
Cycle life	1000 times		

Safety Precautions

- Prohibited action
- Mandatory action
- Situation that needs attention

WARNING

- Stop using the product immediately in the following cases and consult the store you purchased it from. A fire or electric shock may result from continual usage.
 - Smoke, abnormal odors or noises are coming from the product.
 - When the product is wet.
 - Foreign materials or liquid has entered the product. The cable, power plug or case has been damaged.
- Do not touch the power plug or cable when your hands are wet. Doing so can cause fire and electric shock.
- Push the power plug firmly all the way into the household outlet. A loose connection may result in fires and electric shocks.

- Do not forcibly pull or bend the cable, and do not place any heavy objects on it. Doing so can cause external cord damage, disconnection, and lead to a fire or electric shock. Always hold the connector when plugging or unplugging the cable. Not doing so can cause the external cord damage, disconnection, and lead to a fire or electric shock.
- Do not use an extension cord for the power supply. Using an extension cord can cause fires.
- Do not attempt to disassemble or modify the product as it may result in fire, electric shock or injuries.
- Do not put this product in a fire as it may cause an explosion or breakage.

CAUTION

- Before using this product, check that there is no foreign matter such as dust or liquid in the connectors of this device or the device to be connected. Check for the presence of water, especially if a connected waterproof device is wet. Charging when the connector is wet or has foreign matter in it may cause fires, electric shocks, or malfunctions.
- When connecting this product to your device, closely follow the precautions for charging devices.
- Do not use or store the product in the following places as fire, electric shock or malfunctions may result:
 - Places exposed to direct sunlight and locations with high temperatures, such as near a space heater.
 - Places with high humidity or close to water sources.
 - Places with a lot of dust.
 - Places with a lot of vibration.
- Do not use this device with incompatible charging cables as it can cause fire, melting, or malfunctions.
- Do not use or store the product near places that have a lot of dust such as near bedding. Doing so may cause a fire or device failure.
- Stop using this product immediately if you notice damage, such as cracks, deformation or deterioration.
- If the product is not used for a long period of time, disconnect it from the household outlet, otherwise it can cause electric malfunctions.
- Do not drop the product, subject it to strong shocks, or place objects on it.
- Please keep out of reach of children.
- Please note that Elecom Co., Ltd. accepts no responsibility whatsoever for any damage to the device used with this product, or any destruction or loss of data incurred, resulting from your use of this product.
- It is normal for a slight temperature rise of the product to occur during charging.
- Do not use alcohol or other chemicals on this product.

Caution regarding the waterproof and dustproof function

- Do not open the cap when the battery is wet or dirty. Malfunctions can occur when water or foreign matter enters the port. Wipe off all moisture or dirt before opening the cap.
- Tighten the cap and screw it on until it cannot be turned anymore and ensure that there is no gap.
- It may be a little difficult to screw the cap tight. This is normal.
- Note that if the o-ring of the screw plug part is damaged or deformed, the waterproof and dustproof function may not work properly.

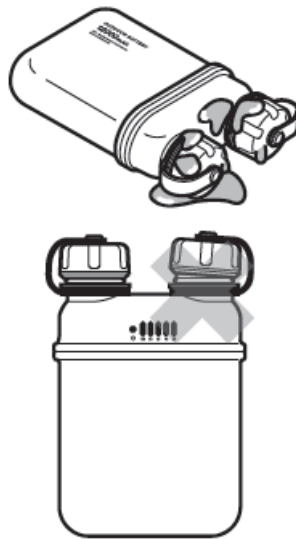

Caution regarding the shock absorber

The shock absorber protects the lithium-ion batteries inside from shocks should this product be dropped. However, do not drop or apply pressure to this product on purpose as it can still be dangerous.

Maintaining and storing this equipment

Charge this product to full before storing it. Charge it once every three months.

Keep it in a cool, dry, and ventilated place. Keep it away from water, flammable gas, corrosive substances, metal dust, and salt.

Regarding the recycling of lithium-ion batteries

A lithium-ion battery is built into the product. Lithium-ion batteries are precious resources that can be recycled, so we request for your cooperation in recycling. Follow the instructions of the local government or authority when disposing of this product.

Please do not remove the batteries by yourself.

Do not dispose of this product as household waste. The destroyed lithium-ion battery inside a garbage truck causes a short-circuit and may lead to a fire or heat generation.

Limitation of Liability

- In no event will ELECOM Co., Ltd be liable for any lost profits or special, consequential, indirect, punitive damages arising out of the use of this product.
- ELECOM Co., Ltd will have no liability for any loss of data, damages, or any other problems that may occur to any devices connected to this product.

Documents / Resources



[ELECOM DE-NEST-5000 Power Bank](#) [pdf] Instruction Manual
DE-NEST-5000 Power Bank, DE-NEST-5000, Power Bank, Bank

References

- [ELECOM USA](#)
- [ELECOM GLOBAL](#)
- [ELECOM USA](#)
- [ELECOM GLOBAL](#)
- [Standards Certification - ELECOM Global](#) | _____

